

Pirámide pentagonal recta de 50mm de altura

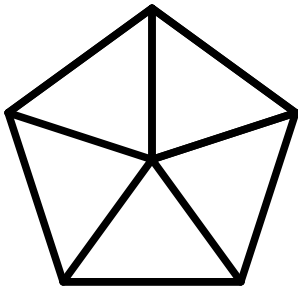

Prisma hexagonal recto de 50mm de altura

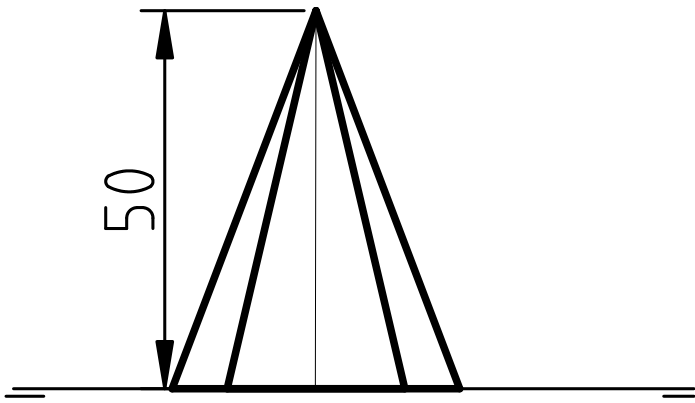
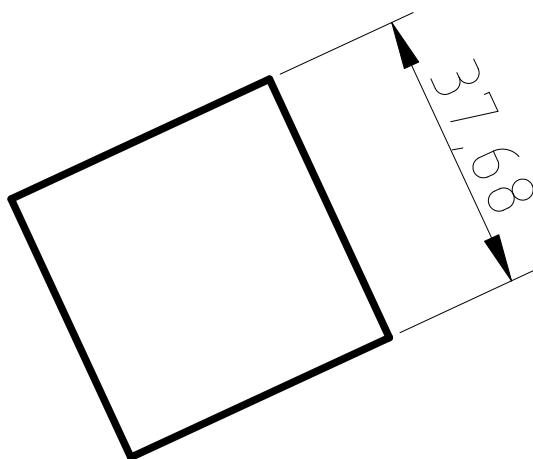
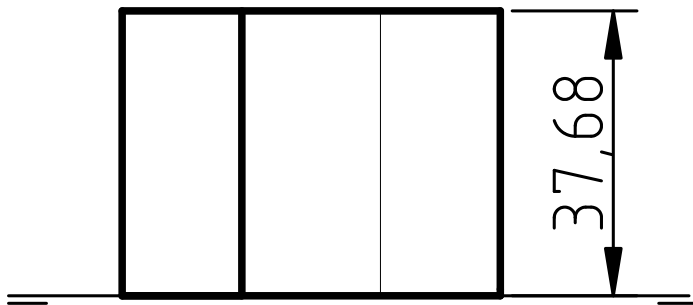
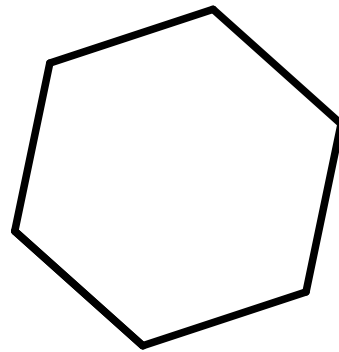
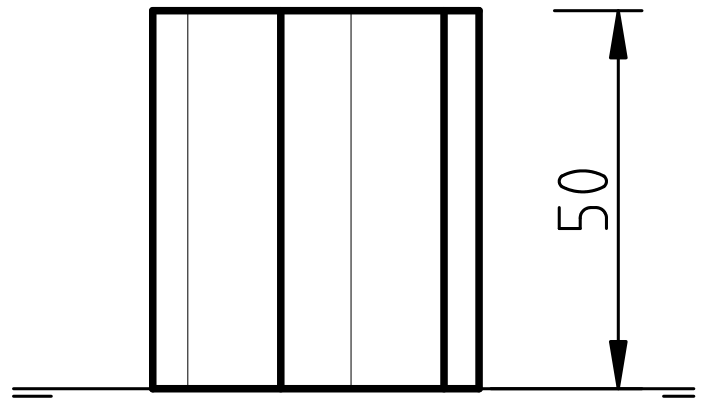

Cubo o hexaedro de arista 37.08mm apoyado en una cara en el PHP. Es poliedro platónico.

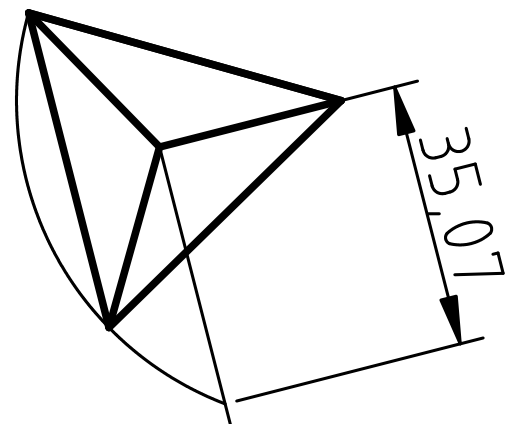
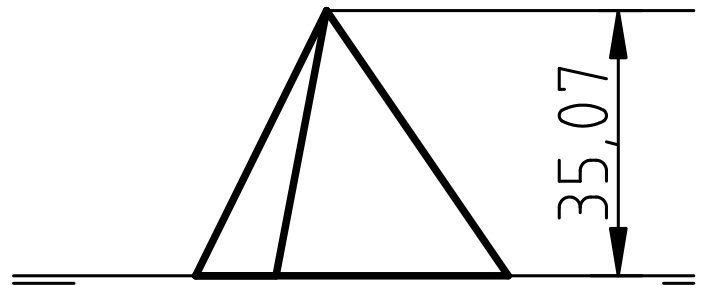

Tetraedro apoyado en una cara en el PHP de altura 35.07mm. Su altura se obtiene de la planta como se indica. Es poliedro platónico.

Fecha	Nombre	VERO SEBASTIÀ
Curso 2º Bach	Título Representación de poliedros	

Cono recto

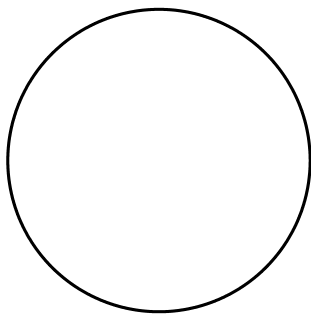
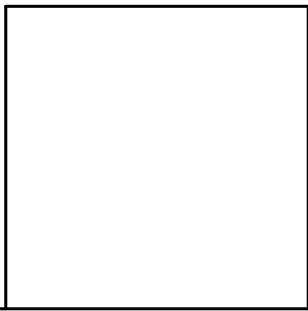
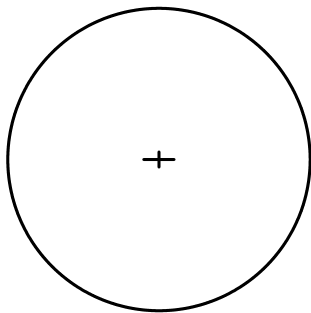
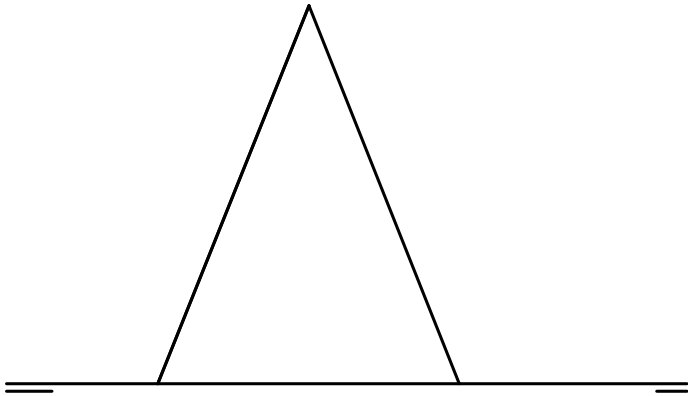

Cilindro recto

Cono recto apoyado en un plano vertical

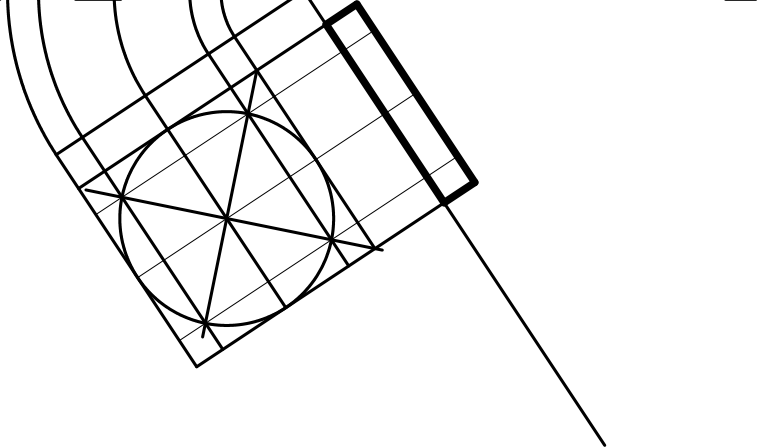
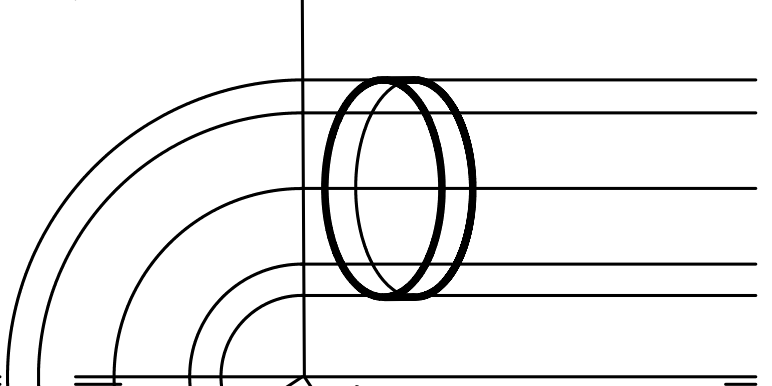
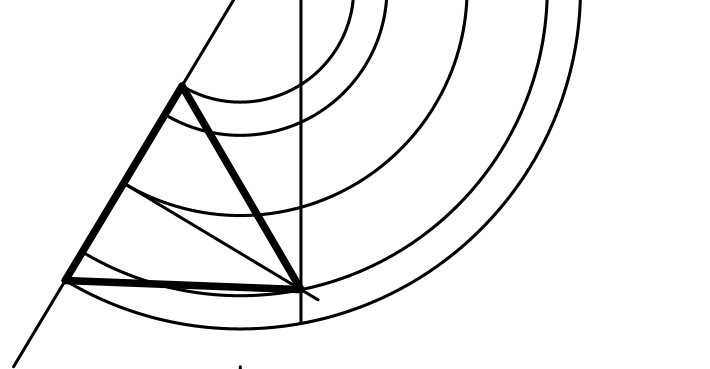
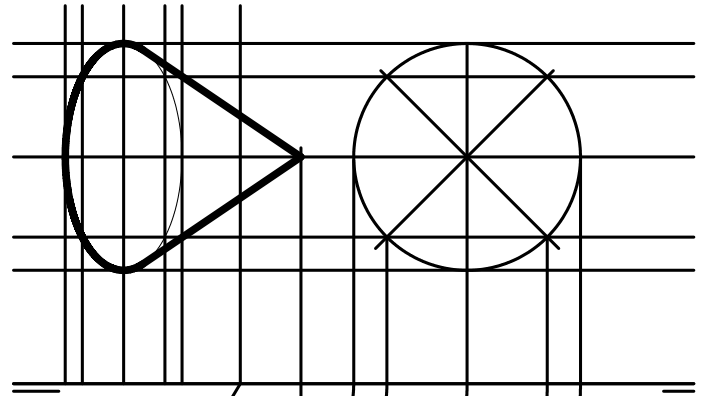

Cilindro recto apoyado en un plano vertical

Fecha

Nombre

Curso 2º Bach

Título Representación de superficies de revolución

VERO
SEBASTIÀ